

**JAB-IN™  
FULL SIZE  
CERAMIC**

## **CERAMIC JAB-IN™ FULL SIZE THERMOCOUPLE CONNECTOR**

- **2-POLE**
- **ONE-PIECE BODY**
- **JAB-IN™ WIRE HOOK-UP**
- **CERAMIC CONSTRUCTION**  
Utilization Temperature to 1000°F(538°C)
- **SUITABLE FOR VACUUM USE**

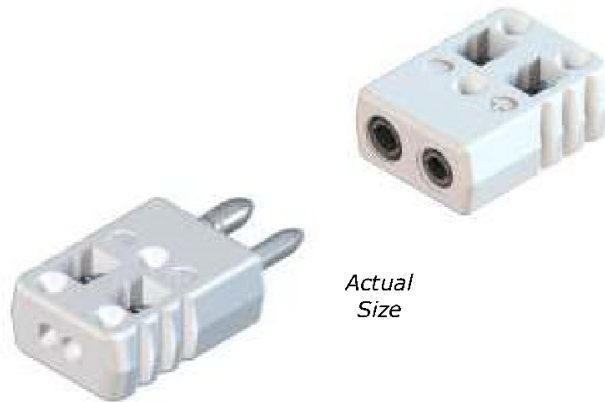

**Marlin** Manufacturing  
Corporation

© Marlin 2011

12800 Corporate Drive  
Cleveland, OH 44130

216-676-1340 800-321-6648 USA  
216-676-1344fax sales@marlinmfg.com

*Wires Jab-In™ for quick reliable hook-up of wires to 14 gage (0.064"). Strip approximately 1/2"*

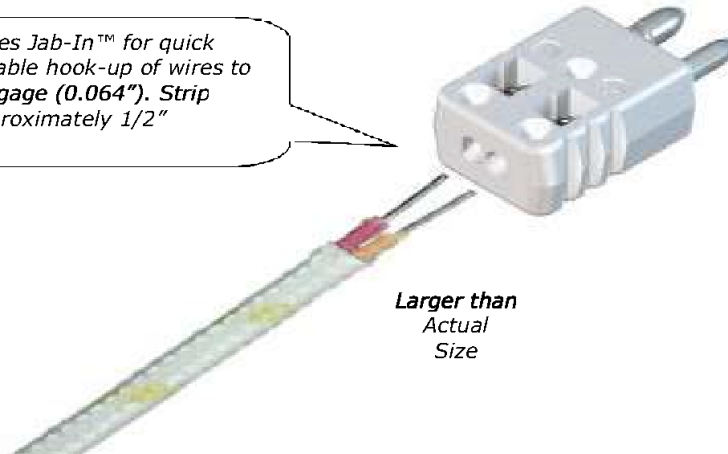

*Larger than Actual Size*

*Standard Full-Size Mounting Hardware fits both Plug and Jack*



*1082 Wire Clamp*

*Soft Insulated thermocouple alloy wire can be strain relieved and held secure via optional adapters*



*1086 Cable Clamp*



*1074 Crimp Adapter*

*MIMS (Mineral Insulated Metal Sheath) Thermocouple can be secured via optional crimp or compression adapters*



*1072 Compression Adapter*

## SPECIFICATIONS

## APPLICATION:

Intended for convenient plug-in connections of thermocouples and thermocouple extensions.

## PURPOSE:

To maintain the integrity of thermocouple circuits by utilizing proper thermocouple alloys and wiring techniques.

## DESCRIPTION

- 2-POLE - Conforms to ASTM E 1129 Dimensional Requirements
- STANDARD (ROUND PINS: Tubular or Solid)
- COMPATIBLE ALLOY CIRCUITRY
- ONE-PIECE BODY
- JAB-IN WIRE HOOK-UP: SS COMPONENTS ( up to 14 gage (0.064" ) )
- CERAMIC CONSTRUCTION
  - Utilization Continuous Use Temperature to 1000°F (538°C)  
(Limitation of Spring Contacts)
  - Intermittent Temperature Limit 1200°F (649°C)  
(Depending On Atmosphere)
  - Suitable for Vacuum use
  - Approximate Ceramic Melting Temperature (N/A—WILL NOT MELT)
- WHITE CERAMIC COLOR
- THERMOCOUPLE TYPE DESIGNATION ON BODY
- POLARITY MOLDED INTO BODY

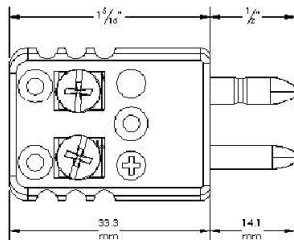

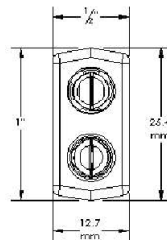

*Plug Jab-In Ceramic  
42C1XX00 Tubular Pins  
42C4XX00 Solid Pins  
XX= Type Designator*

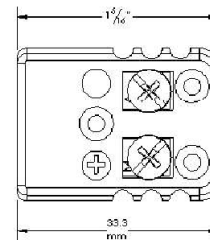

*Jack Jab-In Ceramic  
45C1XX00  
XX= Type Designator*



DESCRIPTION	TYPE	CODE
<b>PLUG CERAMIC JAB-IN</b> 	T J E K N RX SX CX U	42C10100 42C10200 42C10300 42C10400 42C10500 42C10600 42C10700 42C11200 42C10900
<b>PLUG CERAMIC JAB-IN SOLID PIN</b> 	T J E K N RX SX U	42C40100 42C40200 42C40300 42C40400 42C40500 42C40600 42C40700 42C40900
<b>JACK CERAMIC JAB-IN</b> 	T J E K N RX SX CX U	45C10100 45C10200 45C10300 45C10400 45C10500 45C10600 45C10700 45C11200 45C10900