

MC1000 SERIES HANDHELD DIGITAL THERMOMETER



MC1000 is handheld digital thermometer having easy-to-read large LCD display and lighter in weight. Temperature probes having variety of shapes and sizes enable you to select a suitable one on your application demand.

■ FEATURES

- Emphasis on Easy-to-read
- Easy-to-read large LCD display
- Dual displays for measured data and arithmetic result
- Backlit LCD display enables to see under low-light intensity
- Emphasis on Measurement
- Multi-input (thermocouple/RTD) allows various applications
- Calibration function is a standard provision
- Exclusive connector prevents to drop a probe
- Abundant functions
- 20 data storage
- Various computation (max, min, hold, average, alarm, clock)
- 1000 hours battery life



■ MODEL

MC1000-000

■ SPECIFICATIONS

Number of input:	1 point	Data storage:	Up to 20 data
Input types:	Thermocouple type K, T Resistance thermometer Pt100	Computation:	Max/min/average/variables
Sensor connectivity:	Exclusive connector, SM connector	Function:	Hold Alarm Stable condition Temperature compensation Auto power off Clock
Measuring range:	Thermocouple type K -200 to 1370°C Thermocouple type T -200 to 400°C RTD Pt100 -200 to 500°C	Battery:	2 × AA
Display resolution:	1°C -200 to 1370°C 0.1°C -99.9 to 199.9°C (manual setup)	Battery life:	1000 hours while backlight off 100 hours while backlight on
Accuracy ratings:	With a 1°C resolution ±(0.1% of rdg +1°C) With a 0.1°C resolution <K, T> ±(0.1% of rdg +0.5°C) <Pt100> -99.9 to -0.1°C ±(0.1% of rdg +0.3°C) 0.0 to 199.9°C ±(0.1% of rdg +0.2°C) at ambient temperature 20 to 30°C	Working temperature:	0 to 50°C
Display:	3-1/2 digits LCD with backlight	Working humidity:	10 to 80%RH (no dew condensation)
		Dimensions:	76(w) × 164(H) × 36.3(D) mm
		Weight:	approx 250g
		Casing:	ABS resin
		Standard:	CE
		Accessories:	Soft transparent case, batteries, manual

MC1000 SERIES

OPERATION KEYS

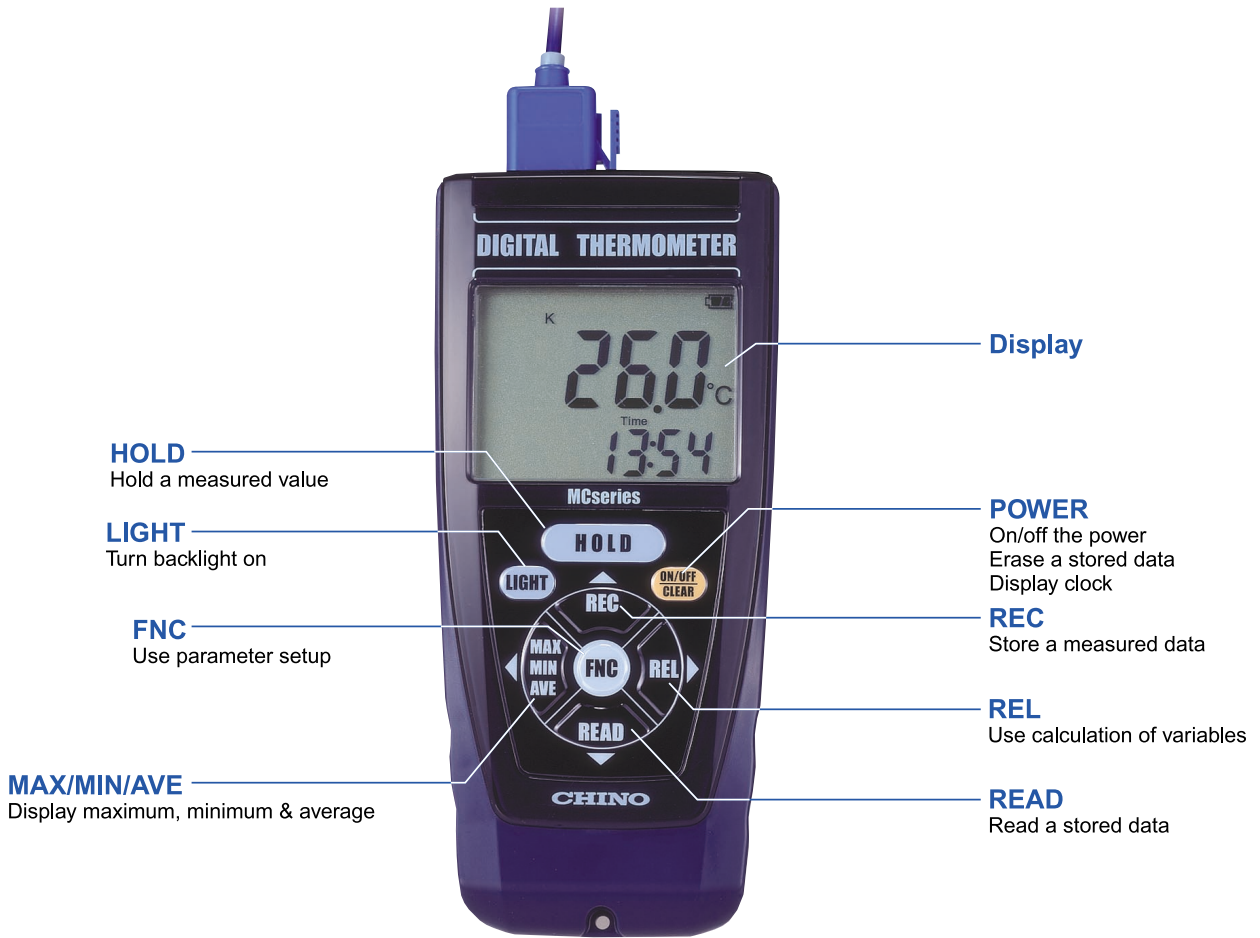

DISPLAY

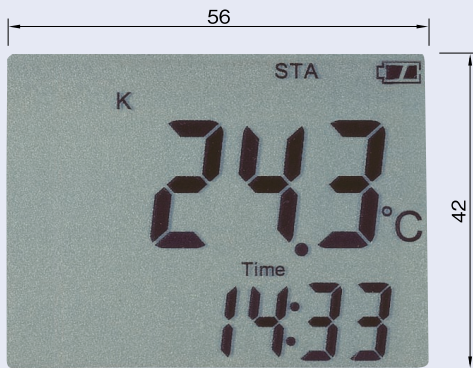

Exact size

EXTERNAL DIMENSIONS

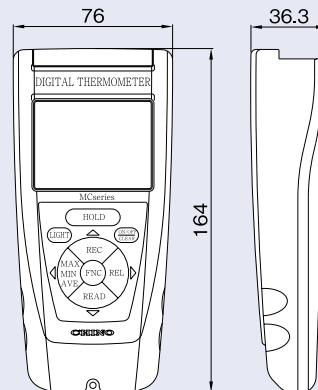

Unit : mm



■ TEMPERATURE PROBES (Thermocouple)

Puressure type: YC510-01K

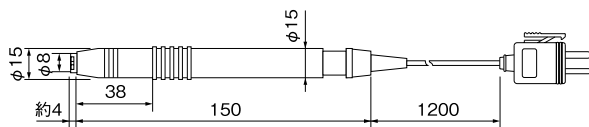

Type: K
 Measuring range: max 500°C (tip material: ceramic)
 Response time: approx 1.8 sec (90% response at aluminum block surface 150°C)

L-shaped pressure type: YC510-05K

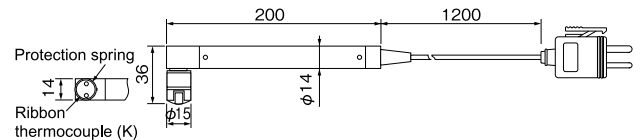

Type: K
 Measuring range: max 500°C
 Response time: 1 sec (90% response at steel plate surface in boiling steam 100°C)

Pressure low-temperature type: YC510-06K, YC510-06T

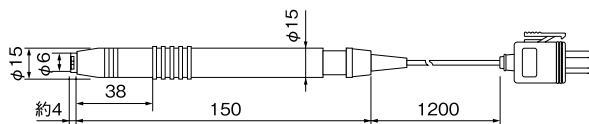

Type: K, T
 Measuring range: max 200°C (tip material: ceramic)
 Response time: approx 1.8 sec (90% response at aluminum block surface 150°C)

Needle type: YC520-□1K, YC520-□1T

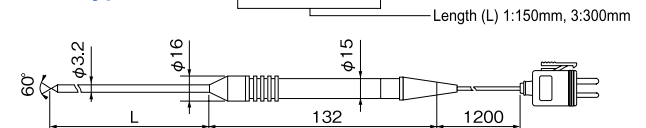

Type: K, T
 Measuring range: max 700°C (max 200°C with type T)
 Tube: ϕ 3.2mm/L150 or 300mm/SUS316
 Response time: 1 sec or faster (90% response in stirred water)

Pressure high-temperature type: YC510-02K

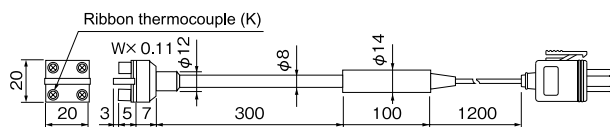

Type: K
 Measuring range: max 800°C
 Response time: 4 sec (90% response at aluminum block surface 340°C)

General type: YC520-□3K, YC520-□3T

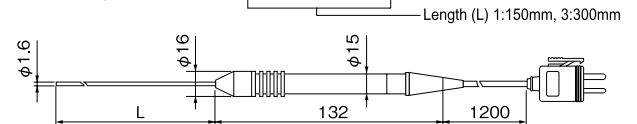

Type: K, T
 Measuring range: max 600°C (max 200°C with type T)
 Tube: ϕ 1.6mm/L150 or 300mm/SUS316
 Response time: 0.4 sec (90% response in boiling water 100°C)

Rapid response pressure type: YC510-03K

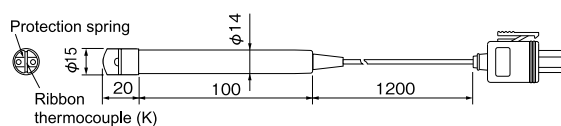

Type: K
 Measuring range: max 500°C
 Response time: 1 sec (90% response at steel plate surface in boiling steam 100°C)

Roller high-temperature type: YC530-02K

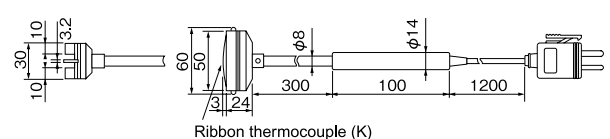

Type: K
 Measuring range: max 800°C
 Response time: approx 2 sec (90% response at aluminum block surface 150°C)

TEMPERATURE PROBES (Thermocouple)

Roller pressuring bearing type: YC530-03K

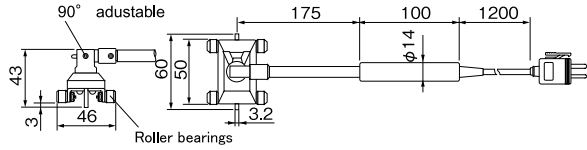

Type: K
 Measuring range: max 250°C
 Response time: approx 2 sec (90% response at aluminum block surface 150°C)

Prong type with arm: YC501-K(Arm), YC511-02K(Probe)

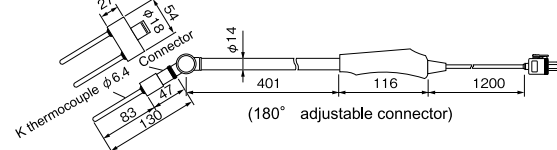

Type: K
 Measuring range: max 600°C
 Response time: 1 sec or faster (90% response at aluminum block surface 600°C)

Pressure type with arm: YC501-K(Arm), YC511-01K(Probe)

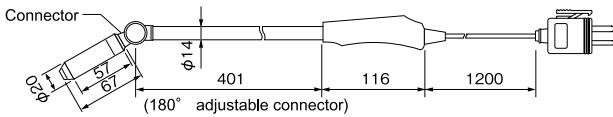

Type: K
 Measuring range: max 500°C
 Response time: approx 1.8 sec (90% response at aluminum block surface 150°C)

Rapid response pressure type with arm: YC501-K(Arm), YC511-03K(Probe)

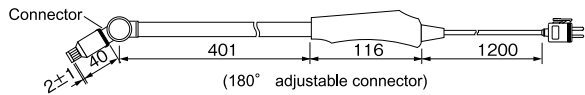

Type: K
 Measuring range: max 500°C
 Response time: approx 1 sec (90% response at steel plate surface in boiling steam 100°C)

TEMPERATURE PROBES (RTD)

General type: YR520-□13

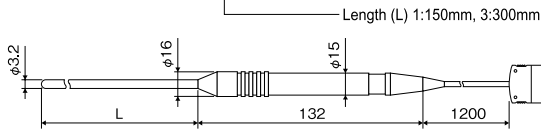

Type: Pt100
 Measuring range: -50 to 300°C
 Response time: approx 6.8 sec (90% response in stirred water)

Rapid response type: YR520-□23

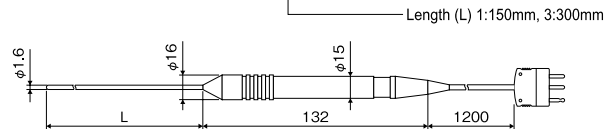

Type: Pt100
 Measuring range: -50 to 300°C
 Response time: approx 2.3 sec (90% response in stirred water)

TERMINAL ADAPTER

For thermocouple MODEL YC507-K-□

Type K, T

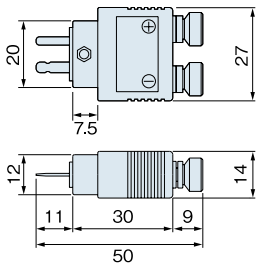

For RTD MODEL YR507

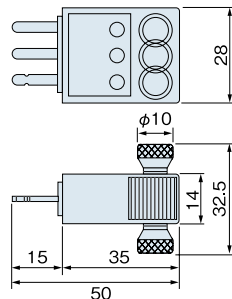

Unit : mm

Connect to industrial sensor

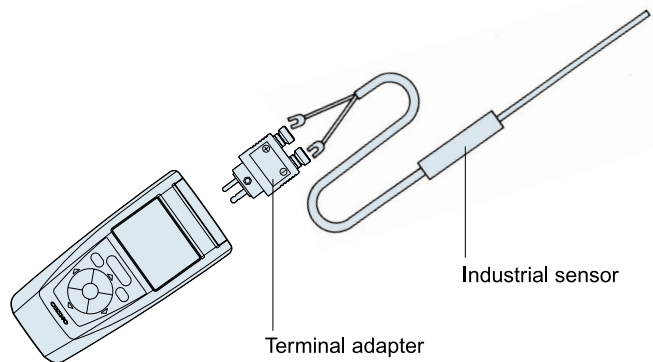

Specifications subject to change without notice. Printed in Japan (I) 2007. 12

CHINO CORPORATION

32-8 KUMANO-CHO, ITABASHI-KU, TOKYO 173-8632
 Telephone : +81-3-3956-2171
 Facsimile : +81-3-3956-0915
 E-mail : inter@chino.co.jp
 Website : http://www.chino.co.jp/